

Mill Bridge Place

Uxbridge • Middlesex • UB8 2XX

PCM: £1,475 PCM



coopers
est 1986



Proud to present this two double bedroom top floor apartment. This apartment is a short walk from Uxbridge town center also Brunel University. This property is ideal for those who enjoy a quiet out of the way complex. located in the hidden distance of the heart of Uxbridge. the location provides great transport links to Underground Tube links to central London and Heathrow.

Accommodation; Two double bedrooms, bathroom, Large lounge, Fitted kitchen with appliances. Benefits; Double glazing, Residents parking, Communal gardens. PART FURNISHED

Close to Uxbridge Town Centre

Great Transport Links

Two Double Bedrooms

Close to Brunel

Close to ACS

Allocated Parking

Part Furnished

Close to Heathrow

Ample Storage Space

Council Tax Band C

Available Date

5th June 2026

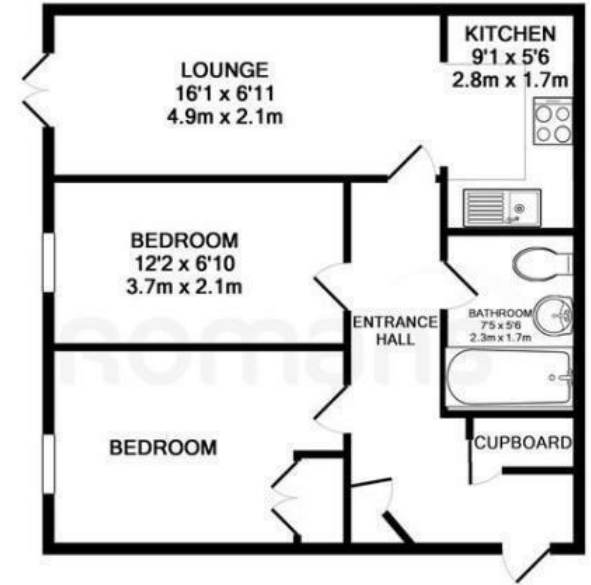
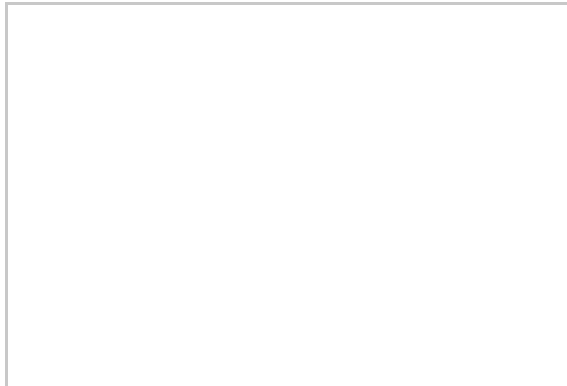

Whilst every attempt has been made to ensure the accuracy of the floor plan contained here, measurements of doors, windows, rooms and any other items are approximate and no responsibility is taken for any error, omission, or mis-statement. This plan is for illustrative purposes only and should be used as such by any prospective purchaser. The services, systems and appliances shown have not been tested and no guarantee as to their operability or efficiency can be given
Made with Metropix ©2019

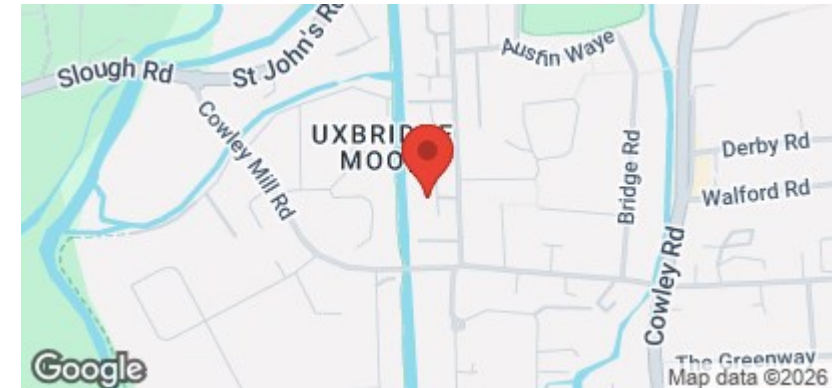

coopers
est 1986

01895 230 103

**109 Hillingdon Hill, Hillingdon Village,
Middlesex, UB10 0JQ**

propertymanagement@coopersresidential.co.uk

CoopersResidential.co.uk

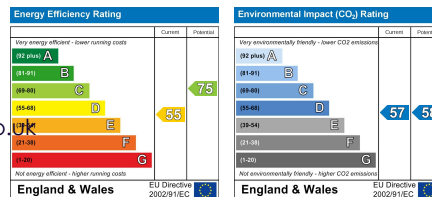

Important Notice: These particulars, whilst believed to be accurate are set out as a general outline only for guidance and do not constitute any part of an offer or contract. Intending purchasers should not rely on them as statements or representation of fact, but must satisfy themselves by inspection or otherwise has the authority to make or give any representation or warranty in respect of the property.